



Installation Instructions

Fixture X-Rev. 2.0 Holophane EMX

READ AND FOLLOW ALL SAFETY INSTRUCTIONS!
SAVE THESE INSTRUCTIONS AND DELIVER TO OWNER AFTER INSTALLATION

- To reduce the risk of death, personal injury or property damage from fire, electric shock, falling parts, cuts/abrasions, and other hazards please read all warnings and instructions included with and on the fixture box and all fixture labels. Before installing, servicing, or performing routine maintenance upon this equipment, follow these general precautions.
- Installation and service of luminaires should be performed by a **qualified licensed electrician**.
- Maintenance of the luminaires should be performed by person(s) familiar with the luminaires' construction and operation and any hazards involved. Regular fixture maintenance programs are recommended.
- It will occasionally be necessary to clean the outside of the refractor/lens. Frequency of cleaning will depend on ambient dirt level and minimum light output which is acceptable to user. Refractor/lens should be washed in a solution of warm water and any mild, non-abrasive household detergent, rinsed with clean water and wiped dry. Should optical assembly become dirty on the inside, wipe refractor/lens and clean in above manner, replacing damaged gaskets as necessary.
- **DO NOT INSTALL DAMAGED PRODUCT!** This luminaire has been properly packed so that no parts should have been damaged during transit. Inspect to confirm.
- These instructions do not purport to cover all details or variations in equipment nor to provide every possible contingency to meet in connection with installation, operation, or maintenance.

	WARNING RISK OF ELECTRIC SHOCK
<ul style="list-style-type: none">✓ Disconnect or turn off power before installation or servicing.✓ Verify that supply voltage is correct by comparing it with the luminaire label information.✓ Make all electrical and grounded connections in accordance with the National Electrical Code (NEC) and any applicable local code requirements.✓ All wiring connections should be capped with UL approved recognized wire connectors.	
	CAUTION RISK OF INJURY
<ul style="list-style-type: none">✓ Wear gloves and safety glasses at all times when removing luminaire from carton, installing, servicing or performing maintenance.✓ Avoid direct eye exposure to the light source while it is on.	

	WARNING RISK OF BURN
<ul style="list-style-type: none">✓ Allow lamp/fixture to cool before handling. Do not touch hot lens, lamp, guard, or enclosure.✓ Do not exceed maximum wattage marked on luminaire label.✓ Follow all lamp manufacturer's warnings, recommendations and restrictions on lamp operation including but not limited to: ballast type, burning position, replacement, and recycling.✓ Use only lamps that comply with ANSI standards.	
	CAUTION RISK OF FIRE
<ul style="list-style-type: none">✓ Keep combustible and other materials that can burn away from lamp/lens.✓ Do not operate in close proximity to persons, combustible materials or substances affected by heat or drying.	



Installation Instructions

Fixture X-Rev. 2.0 Holophane EMX

Luminaire Applications: Fixture X-Rev. 2.0 Holophane EMX commercial fixture is an enclosed and gasketed unit rated for wet locations and can be water pressure washed with all commercial washers. The fixture is designed for ceiling and wall mounting where heavy environmental conditions exist.

The standard tunnel fixture #1 is designed for mounting horizontally in bored, round or other tunnels at a height of 7' from walkway to lowest part of fixture with the included Rigid Mount Bracket (RMBK). For cut/cover tunnels with vertical walls, the Angled Rigid Mount Bracket (RMBA) Set is required to tilt the fixture to illuminate the walkway below. Note: The RMBA must be ordered separately from the fixture.

The blue tunnel fixture #2 is the same as the standard but with a blue frosted lens. The blue lens set can be ordered as a separate part and installed by the user.

Part Numbers: Go Green Fixture X Rev. 2.0 EMX Holophane Transit Fixtures

The fixtures can be supplied in one of two ways:

1. **Go Green Tunnel Fixture X- Rev. 2.0** (4' EMX Holophane 4000K)
(Comes with (2) Rigid Mount Brackets-RMBK)
2. **Go Green Blue Tunnel Fixture X- Rev. 2.0** (4' EMX Holophane 4000K)
(Comes with Blue internal color lens and (2) Rigid Mount Brackets-RMBK)

Tunnel Applications:

Normal application in bored/round tunnel

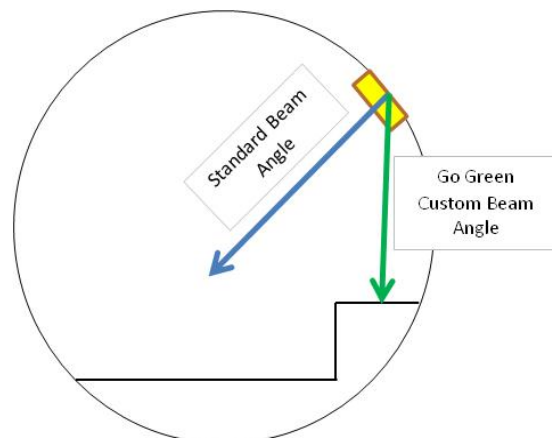



Installation Instructions

Fixture X-Rev. 2.0 Holophane EMX

Mounting Bracket Options:

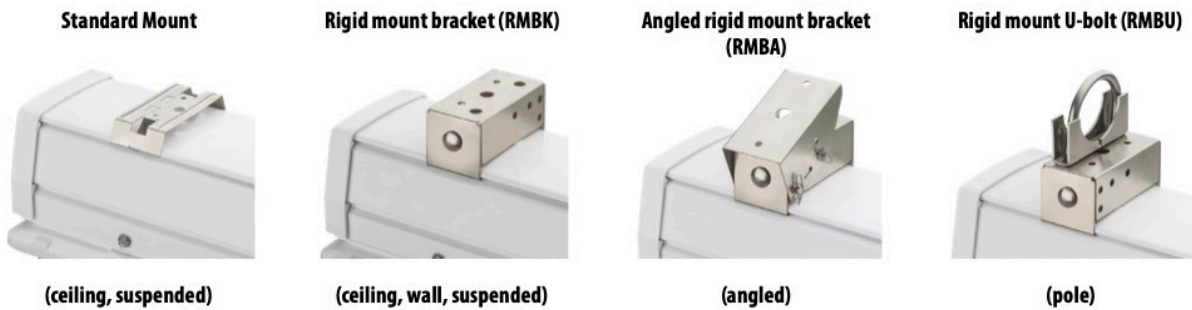

Spare Parts & Accessories:

- Replacement Standard Bracket Set (2)
- Replacement Rigid Mount Bracket Set (2)
- Angled Rigid Mount Bracket Set (2)
- Rigid Mount U Bracket Set (2)
- Replacement White Frosted Polycarbonate Lens Set (2)
- Replacement Blue Frosted Polycarbonate Lens Set (2)
- Replacement Internal Littlefuse holder assembly & 3a fuse
- Replacement Internal 120volt Driver
- Replacement Internal 277volt Driver
- Replacement Internal 120-277volt Driver
- Replacement Internal 383-480volt Driver

- #SMBK
- #RMBK
- #RMBA
- #RMBU
- #EMX-WFL-2
- #EMX-BFL-2
- #LHR/LGR-3
- #EMX-MD120
- #EMX-MD277
- #EMX-MDMVOLT
- #EMX-MDHVOLT

Angled Rigid Mount Bracket for use in cut/cover tunnels with vertical walls. Bracket attaches to fixture with hardware as shown.





Installation Instructions

Fixture X-Rev. 2.0 Holophane EMX

IMPORTANT LED SAFETY INSTRUCTIONS

- ✓ Never connect components under load.
- ✓ Do not mount or support fixture in a manner that can cut the outer jacket or damage the wire insulation.
- ✓ Unless individual product specifications deem otherwise: Never connect an LED product directly to a dimmer pack, occupancy sensors, timing devices, or other related control devices. Fixtures must be powered directly off a switched circuit.
- ✓ Unless individual product specifications deem otherwise: Do not restrict fixture ventilation. Allow for some volume of airspace around fixture. Avoid covering LED fixtures with insulation, foam, or other material that will prevent convection or conduction cooling.
- ✓ Unless individual product specifications deem otherwise: Do not exceed fixtures maximum ambient temperature.
- ✓ Only use fixture in its intended location.
- ✓ LED products are Polarity Sensitive. Ensure proper Polarity before installation.
- ✓ Electrostatic Discharge (ESD): ESD can damage LED fixture components. Personal grounding equipment must be worn during all internal servicing of the unit.
- ✓ The internal driver, LED board and fuses are designed to be serviced by qualified, trained LA Metro electricians. In the unlikely event your unit may require service, contact a Go Green Solutions representative for assistance. Some components inside the fixture may not be serviceable. In the event your unit may require a d d i t i o n a l service, stop using the unit immediately and contact a Go Green Solutions representative for assistance.
- ✓ Always read the fixtures complete installation instructions prior to installation for any additional fixture specific warnings.
- ✓ This luminaire contains electronic devices that generate frequencies above 9kHz from components within the luminaire & complies with Part 15 of the FCC Rules. Operation is subject to the following two conditions:
 - (1) This device may not cause harmful interference
 - (2) This device must accept any interference received, including interference that may cause undesired operation

Failure to follow any of these instructions could void product warranties.



Installation Instructions

Fixture X-Rev. 2.0 Holophane EMX

INSTALLATION INSTRUCTIONS

INSTALLATION OF THIS FIXTURE IN ANY OTHER MANNER THAN WHAT IS INDICATED WITHIN THESE INSTRUCTIONS WILL VOID ALL WARRANTIES.

These instructions are for fixture level installation:

Ensure proper voltage will be supplied to the fixture. Check the fixture label on the carton for fixture voltage. Fixture must be grounded before use. Remove fixture from packaging and check for damage. Care should be taken to protect fixture during handling. Remove plastic film from lens prior to installation.

MOUNTING METHODS

Mounting options must be specified when ordered. The EMX fixture is supplied with one set of two (2) standard or rigid mounting brackets. Please refer to the specification sheet when determining acceptable mounting options for specific applications.

- **Surface Suspended-** bolted, chain, cable
 - Standard mounting bracket
 - Rigid mounting bracket (RMBK)
- **Surface Angle (ceiling, wall, angle)**
 - Rigid mounting Angle Bracket (RMBA)
- **U-bolt pole mounting**
 - 1 ½" Trade size Pipe mounting (RMBU)



GENERAL INSTALLATION

For all mounting methods ensure facility mounting points and mounting hardware (provided by others) are rated for 4 times the fixture weight, approximate fixture weight is 20 lbs (4ft). The fixture bracket mounting spacing is MAX 43.7" apart. The mounting brackets adjust inside the integrated fixture mounting rail to accommodate custom mounting positions.



Installation Instructions

Fixture X-Rev. 2.0 Holophane EMX

Standard Mounting Bracket INSTALLATION

1. Install the mounting brackets to the facility mounting points MAX 43.7" apart.
2. Hang fixture inside one edge of the 2 installed brackets and rotate up to snap in the other edge of the bracket. The fixture will snap into bracket.



RMBK INSTALLATION

1. See Figure to right for RMBK Detail.
2. Install the RMBK mounting brackets to the facility mounting points MAX 43.7" apart.
3. Hang fixture inside one edge of the 2 installed RMBK Brackets and rotate up to snap in the other edge of the bracket. The fixture will snap into RMBK bracket.
4. Install the carriage bolt and nut into both RMBK Brackets and tighten nut down to 13 in-lb. Make sure the power cord is not pinched between the fixture housing and RMBK mounting brackets.

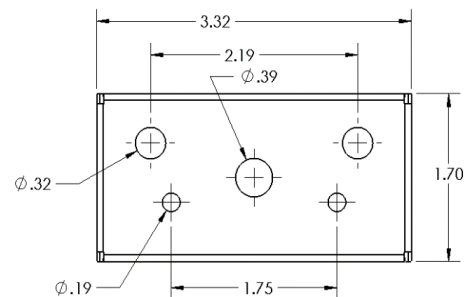



Installation Instructions

Fixture X-Rev. 2.0 Holophane EMX

RMBA INSTALLATION

1. Set the RMBA mounting brackets to desired angle using set pin. Install the RMBA mounting brackets to the facility mounting points MAX 43.7" apart.
2. Hang fixture inside one edge of the 2 installed RMBA brackets and rotate up to snap in the other edge of the bracket. The fixture will snap into RMBA bracket.
3. Install the carriage bolt and nut into both RMBA Brackets and tighten nut down to 13 in-lb. Make sure the power cord is not pinched between the fixture housing and RMBA mounting brackets.



DRIVER & WIRING ACCESS

1. Remove the end cap by removing the 4 screws shown on wire entry end of fixture.
2. Make the electrical connection to the fixture in accordance with your local electrical code. Make all necessary wiring connections, observing proper voltage and polarity. ALL Wire entry openings must be sealed during installation.

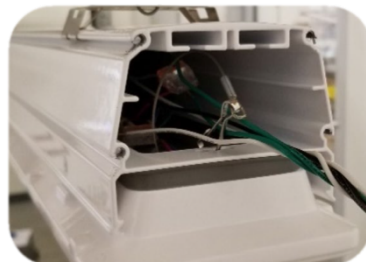



Installation Instructions

Fixture X-Rev. 2.0 Holophane EMX

DRIVER, LED BOARD & FUSE SERVICE ACCESS

When full channel access is required or when performing maintenance, the light engine and driver may be removed/replaced. **PLEASE NOTE* Moderate force is required to reinstall the light engine.**

To remove the light engine, remove the 4 screws per light engine 2 located on each side of fixture. Insert flat tip screwdriver into opening directly under screw hole and pry downward to shift the light engine away from the housing. Repeat for the second screw hole on the same side of the light engine. The light engine will swing down and hang by a tether on one end of the housing to allow easy access to the wireway.



Before reassembling, make sure gasket is properly seated as shown at right.





Installation Instructions

Fixture X-Rev. 2.0 Holophane EMX

To close, align the snaps onto the channel on one side and rotate up and squeeze light engine and driver housing together to snap into place.

PLEASE NOTE* Moderate force is required to squeeze light engine into position. Once snapped, reinstall the 4 screws per light engine to secure in place.



BURN IN & TEST PROCEDURE

EMX fixtures are required to be energized continuously for 24 hours under normal electrical supply conditions to insure that the system has been properly installed and wired.

WARRANTY & GUARANTEE

Go Green Solutions warrants all EMX fixtures against failures for products used under normal conditions and installed correctly under these Installation Instructions for a period of **10 years** from date of purchase. Go Green Solutions warrants the lumen maintenance to L70 for the warranty period.

For information on how to recycle LED electronic products, please visit www.epa.gov.

For more information please contact: **Go Green Solutions 626-578-0678**

www.GoGreenSolutions.com

This page left blank